

Permit Fee: \$40.00

City of Perham Utility Connections/Right of Way Permits Office
125 2nd Avenue NE, P. O. Box 130, Perham, Minnesota 56573
Phone # 218-346-4455

APPLICATION FOR RIGHT OF WAY PERMITS

Excavation Permit

Obstruction Permit

Attached Plan Submitted by (Applicant):	
Location:	
From and To (Address/Location)	
Applicant: _____	
Address: _____	
City: _____	State: _____ Zip: _____ Bonding Company _____
Contact Person: _____	Insurance Company _____
Cell Phone#: _____	24 Hour Phone: _____
Facilities Information	
<input type="checkbox"/> Cable TV <input type="checkbox"/> Cooling <input type="checkbox"/> Traffic <input type="checkbox"/> Heating <input type="checkbox"/> Water <input type="checkbox"/> Sewer <input type="checkbox"/> Telecom. <input type="checkbox"/> Fiber <input type="checkbox"/> Gas: _____ <input type="checkbox"/> High Pressure <input type="checkbox"/> Low Pressure <input type="checkbox"/> Electrical, Voltage: _____ <input type="checkbox"/> Other: _____	Conduit (Size & Kind): Cable (Size & Type):
Purpose of Construction	
New: _____ Replacement: _____ Repair: _____ Other: _____	
Type of Construction	
Trench _____ Hole _____ Chamber _____ Bore (Specify) _____ Aerial _____ Plow (Specify) _____ Other: _____	
Construction Details	
Excavation Size: _____ Length: _____ Width: _____ Depth: _____ Total Linear Footage Installed: _____	
ROW being used: _____ Driving Lane _____ Parking Lane _____ Sidewalk _____ Blvd. Type of material: _____ Concrete _____ Bituminous _____ Gravel _____ Sod _____ Field Grass _____ Trees _____ Shrubs Structures: _____ Curb & Gutter _____ Sidewalk _____ Signals _____ Other: Shoulders: _____ Bituminous _____ Gravel _____ Road Signs _____ Culvert _____ Other	
Construction Schedule	
Estimated Starting Dates: _____ Estimated Ending Dates: _____ Working hours are between 7 am and sunset. Prior approval is needed for work on Sundays.	

I have read and agree to comply with all applicable City Codes.

Applicants Signature: _____
Date : _____

Date Received: _____
Approval Date: _____
Permit Number: _____
PWD _____

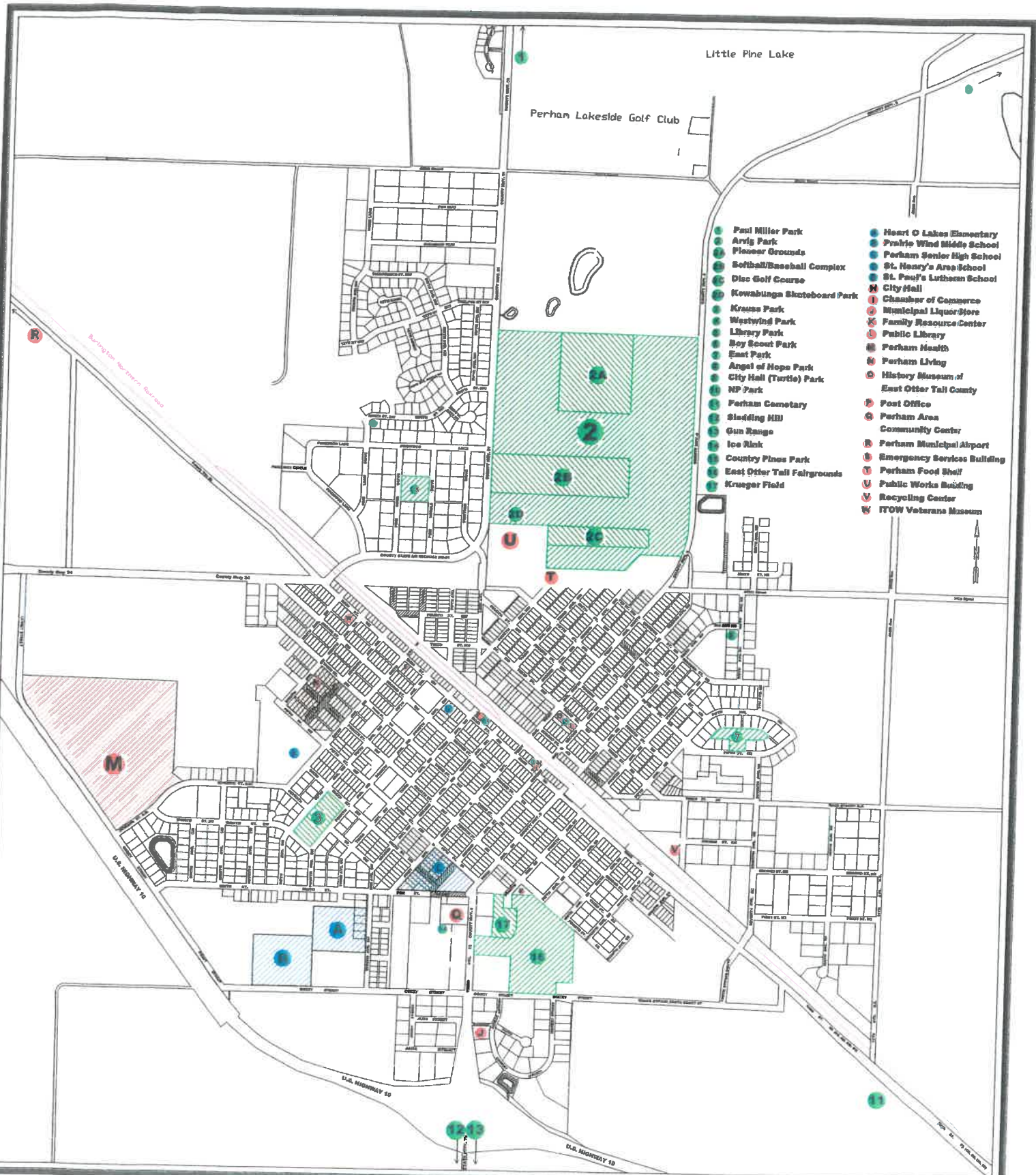

Little Pine Lake

Perham Lakeside Golf Club

- Paul Miller Park
- Arvig Park
- Ploesser Grounds
- Softball/Baseball Complex
- Disc Golf Course
- Kowabunga Skateboard Park
- Krauss Park
- Westwind Park
- Library Park
- Boy Scout Park
- East Park
- Angel of Hope Park
- City Hall (Turtle) Park
- NP Park
- Perham Cemetery
- Sledding Hill
- Gun Range
- Ice Rink
- Country Pines Park
- East Otter Tail Fairgrounds
- Krueger Field
- Heart O Lakes Elementary
- Prairie Wind Middle School
- Perham Senior High School
- St. Henry's Area School
- St. Paul's Lutheran School
- City Hall
- Chamber of Commerce
- Municipal Liquor Store
- Family Resource Center
- Public Library
- Perham Health
- Perham Living
- History Museum of East Otter Tail County
- Post Office
- Perham Area Community Center
- Perham Municipal Airport
- Emergency Services Building
- Perham Food Shelf
- Public Works Building
- Recycling Center
- ITOW Veterans Museum



Detroit Lakes - Minneapolis - Bismarck - Fargo - Sioux Falls
 1041 Hawk Street, P.O. Box 150
 Detroit Lakes, Minnesota 56502-0150
 Phone: 218.847.5607 Fax: 218.847.2791
 Web: www.ultelg.com
 Drawn By: C.M.B.
 Checked By: J.A.B.
 Approved By: J.A.B.



CITY MAP

Date: January 2012
 Sheets: 1 of 1